

Kitchen and Bathroom Remodel

If you are replacing countertops, fixtures or cabinets in the same location, then a permit is not required. A building permit would be required if you are adding an island relocating appliances or fixtures in the kitchen or bathroom. When you rearrange appliances, fixtures and cabinets electrical and plumbing requirements must be met. This document is to be used as a guide only and cannot possibly cover all situations, nor is it intended to do so. If you have any questions, please contact the Building Official at 860-228-5971 ext. 142 or jsummers@hebronct.com

Minimum Requirements

Construction Document Requirements

- Floor plan of entire area to be remodeled
- Uses of all spaces are identified
- Clearly distinguish new work from existing
- Indicate framing type to be used
- Indicate insulation methods and values
- Ceiling height and type of ceiling
- Type and location of permanent heat source
- Make-up air and combustion air will need to be addressed for fuel-burning appliances provide the input BTU ratings

Smoke Alarms and CO Detectors

- Smoke alarm – shall be installed in each sleeping room, outside each separate sleeping area in the immediate vicinity of the bedrooms and on each additional story of the dwelling (R314.3)
- Carbon monoxide alarms – shall be installed outside of each sleeping area in the immediate vicinity of the bedrooms and on each additional habitable level of the dwelling unit except for dwellings units not containing a fuel-burning appliance, fireplace or attached garage (CT Amd 315.1)
- Alterations, repairs and additions shall require smoke and CO alarms in all areas stated above (CT Amd R314.3.1, Ct Amd R315.2)

Electrical Requirements

- Habitable rooms shall have receptacles installed so that no point measured horizontally along the floor line in any wall space is more than 6 feet from a receptacle outlet (E3901.2.1)
- Wall space is any space that is 2 feet or more in width, including around corners and that is unbroken along the floor line by doorways, fireplaces, and similar openings (E3901.2.2)
- Receptacles shall be of the tamper-resistant type, except if located more than 5.5 feet above the floor, part of a luminaire or appliance or dedicated for the appliance served (CT Amd E4002.14) (NEC 406.12)
-

Finished Rooms

- Requires a permanent heat source that is capable of maintaining a temperature of 68°F, 36” above the floor, 24” from the exterior wall in all habitable areas (R303.8).
- Ceiling height – 7'-0” clearance, except under beams, girders, pipes, ducts or other obstructions shall be minimum 6'-6” (CT Amd R305.1, exception #1)

Bathrooms

- At least one wall receptacle outlet shall be installed in bathrooms and such outlet shall be located within 36 inches of the outside edge of each lavatory basin and not more than 12” below the countertop. (E3901.6)
- Hydromassage bathtubs and their associated electrical components shall be supplied by an individual branch circuit(s) and protected by a readily accessible GFCI (E4209.1)
- All 125-volt, 15- and 20-ampere receptacles installed in bathrooms shall have GFCI protection. (E3902.1)

Kitchen

- All 125-volt, 15- and 20-ampere receptacles that serve countertop surfaces shall have GFCI protection (E3902.6)
- Receptacles shall be located not more than 20” above the countertop nor more than 12” below the countertop for island and peninsular countertops (E3901.4.5)
- Receptacle spacing shall be in accordance with the following diagrams

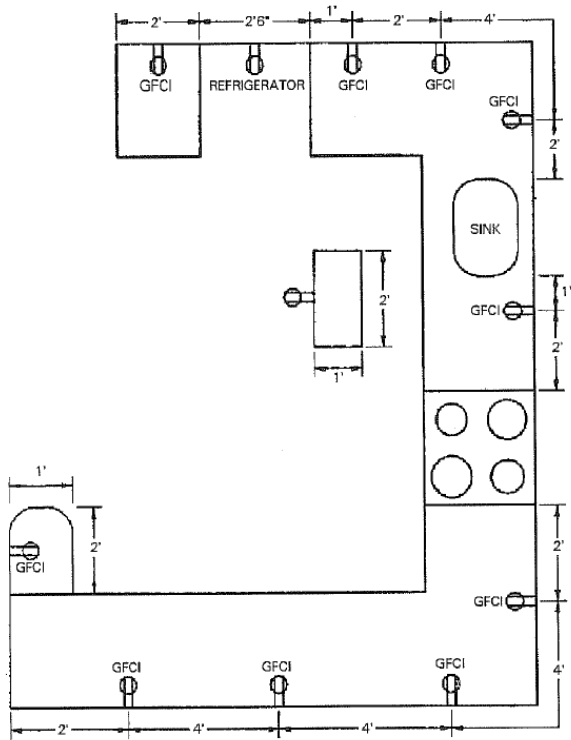

For SI: 1 foot = 304.8 mm.

**FIGURE E3901.4
COUNTERTOP RECEPTACLES**

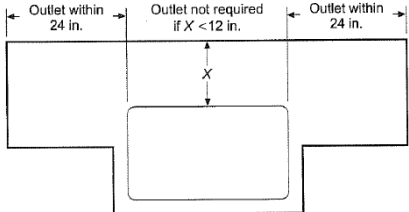

Sink, range or counter-mounted cooking unit extending from face of counter

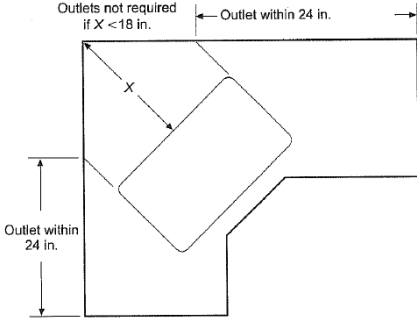

Sink, range or counter-mounted cooking unit mounted in corner

For SI: 1 inch = 25.4 mm.

**FIGURE E3901.4.1
DETERMINATION OF AREA BEHIND SINK OR RANGE**